

EXISTING SITE ID: N/A	NEW APT ID: A1028/APT16	ROAD TYPE:	<input type="checkbox"/> Local	<input type="checkbox"/> Secondary	<input type="checkbox"/> Main	ASSET TYPE:	REINSTATEMENT:		SIGNIFICANT GRADIENT:		OHS CONSIDERATIONS:		
MAIN STREET: SYDNEY PLACE AT DOWLING STREET		AREA:	<input type="checkbox"/> Residential	<input type="checkbox"/> Commercial	<input type="checkbox"/> Industrial	<input type="checkbox"/> Communication Pylon	<input checked="" type="checkbox"/> Asphalt	<input type="checkbox"/> Other	Lengthwise	Y	N	<input type="checkbox"/> Overhead Cables	<input type="checkbox"/> Other
CROSS STREET: DOWLING STREET		SITE ZONE:	<input type="checkbox"/> CBD Zone	<input type="checkbox"/> Village Area	<input type="checkbox"/> Other	<input type="checkbox"/> Bus Shelter	<input type="checkbox"/> Brick		Width Wise	Y	N	<input type="checkbox"/> Underground Cables	
OUTSIDE/OPP:		JCD NO.:	A1028/APT16	APT TYPE:	SINGLE	<input type="checkbox"/> Bus Shelter Narrow	<input type="checkbox"/> Concrete		FOOTPATH WIDTH:			<input type="checkbox"/> Gas Main	
ROAD DIRECTION:		AD TYPE:	<input type="checkbox"/> AD	CONFIG:	LH	<input type="checkbox"/> Kiosk	<input type="checkbox"/> Concrete Paving		Actual Footpath Width			<input type="checkbox"/> Water Main	
ADDITIONAL AD POTENTIAL:	<input type="checkbox"/> Yes <input type="checkbox"/> No		<input checked="" type="checkbox"/> Non-AD	GREEN ROOF:	NO	<input checked="" type="checkbox"/> APT	<input type="checkbox"/> Specialist Paving		Narrow Kiosk Required	Y	N	<input type="checkbox"/> Telephone	
POTENTIAL ADVERTISEMENTS:	D = Digital S = Static G = Green Wall		COMMENTS:				<input type="checkbox"/> Unmade/Grass		Narrow Footpath	Y	N	<input type="checkbox"/> Traffic Management	
Face A	G	Face B	G	Face C	G				<1.2m clear path or <1.8m clear path in City Centre/Village Main Street			<input type="checkbox"/> Access Issues	

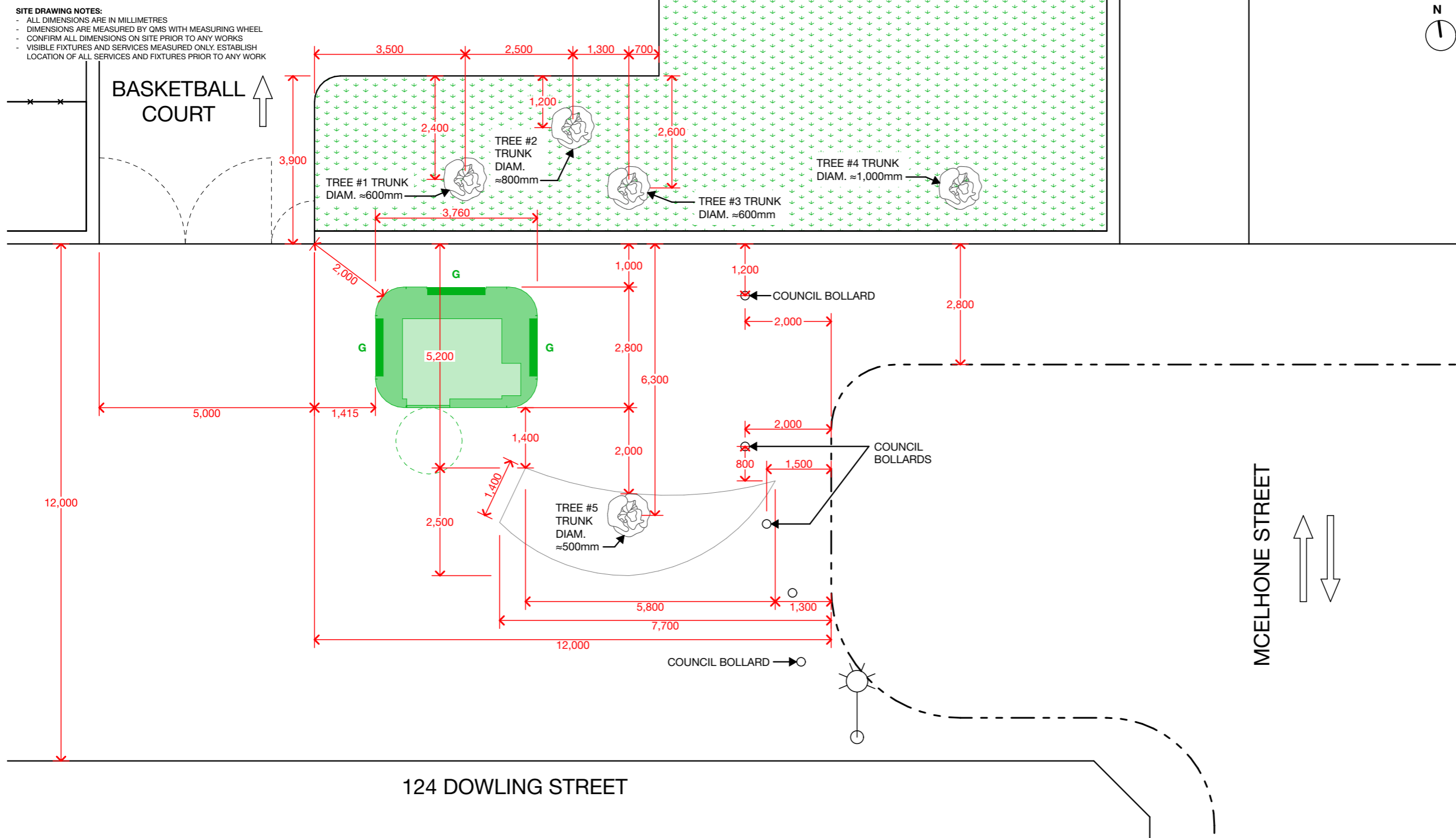

- PLANNING APPLICATION NOTES:**
1. The proposal relates to the APT and advertising signage panel.
 2. Refer to the DA Master Matrix for the APT Type. Drawings for each APT Type can be found in the Schedules of the SEE.
 3. Tactile Ground Surface Indicators are indicative only. All TGSI to comply with AS1428.4.1

LEGEND

- NEW AUTOMATIC PUBLIC TOILET (APT)
- WHEELCHAIR MANOEUVERING AREA
- EXISTING APT OUTLINE
- EXISTING BENCH SEAT
- BIN
- TREE (NTS)
- POWER POLE
- SMART POLE/LIGHT POLE
- SERVICE PIT
- UNKOWN SERVICE PIT
- TRAFFIC LIGHT
- SIGN POST/LOADING ZONE/PARKING
- BIKE RACK
- GRASS
- PLANTER BED
- TACTILE INDICATOR-EXIST
- STREET KERB
- FENCE

DATE: 3/6/2024
SCALE: 1:100@A3
DRAWN: BAT
SURVEY NO.: A1028/APT16

ISSUE | **DESCRIPTION** | **DATE** | **DRAWN**

07 | APTs - UPDATES | 3/6/2024 | BAT

LOCATION PLAN - PROPOSED

EXISTING SITE ID: N/A
NEW APT ID: A1028/APT16

